

| 4 | | | | |
|------|-----|-------------|------|-------|
| 3 | | | | |
| 2 | | | | |
| 1 | | | | |
| ZONE | REV | DESCRIPTION | DATE | APPD. |

R&D發行
2017.02.23
達立

RoHS
Compatible

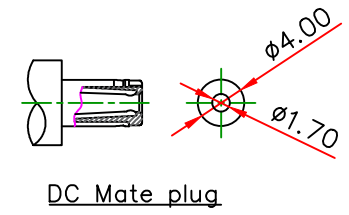
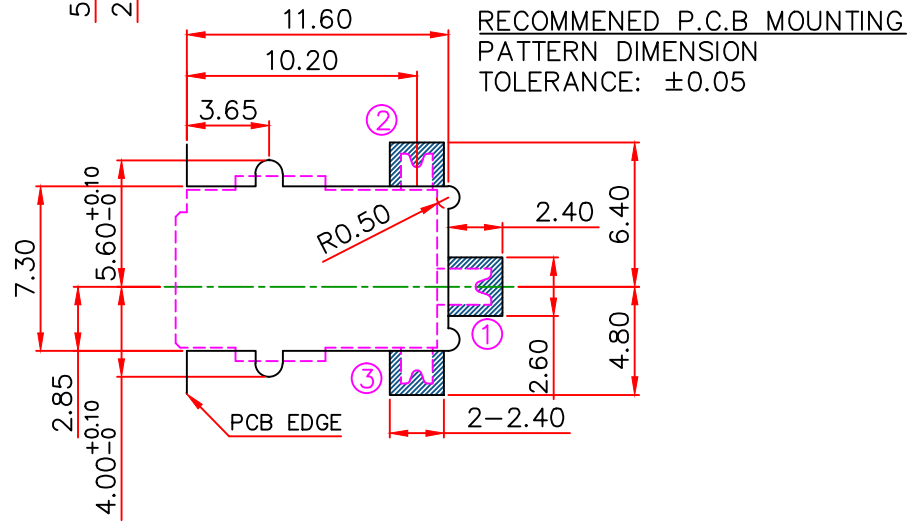
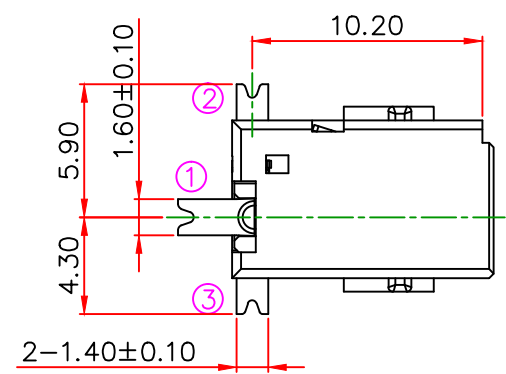
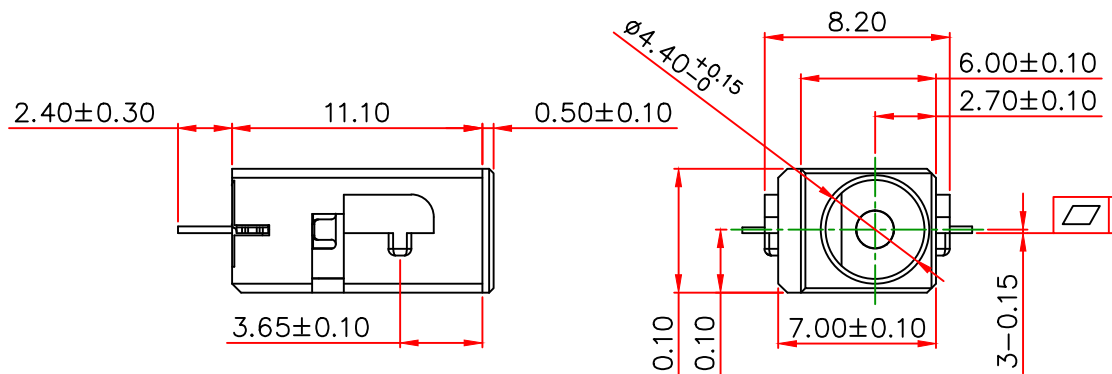
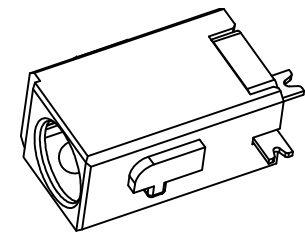

Material :
Terminal 1 : Brass, Ag Plated
Terminal 2 : Copper alloy, Ag Plated
Terminal 3 : Brass, Ag Plated
Housing : PA10T

| | |
|------------|---------|
| Schematic | |
| Center Pin | ø1.65mm |

達立科技股份有限公司
Dawning Precision Co., Ltd.
TEL: 886-2-82271388 FAX: 886-2-82272198

| | | | | | |
|----------|-------|---------|-------------|--|--|
| DESIGN | Eason | SCALE | | | TOLERANCE UNLESS OTHERWISE STATED(mm) 0 _____ ±0.50 0.0 _____ ±0.30 0.00 _____ ±0.20 ANGLE _____ ±2° |
| DRAWING | Eason | UNIT | mm | | |
| CHECK | Eason | SIZE | A4: 210*297 | | |
| APPROVAL | Honda | VERSION | 02 | | |

| | |
|------------|-----------------|
| PART NAME | DC POWER SOCKET |
| PART NO | DC-095DH |
| DRAWING NO | |
| DATE | 2017/02/23 |