

| | | | | |
|------|-----|-------------|------|-------|
| △ | | | | |
| △ | | | | |
| △ | | | | |
| △ | | | | |
| ZONE | REV | DESCRIPTION | DATE | APPD. |

R&D發行
2017.04.18
達立

RoHS
Compatible

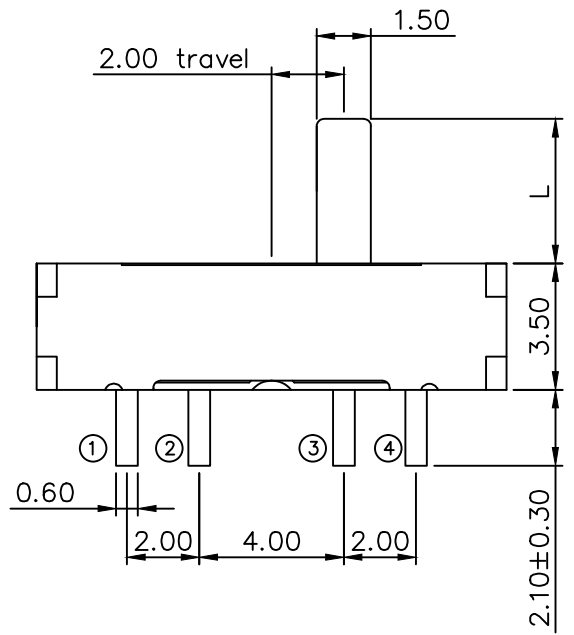

CIRCUIT DIAGRAM

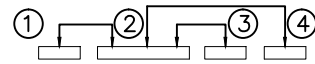

| Model | L(mm) |
|-------|-------|
| C80 | 2.00 |
| C80A | 4.00 |

RECOMMENED P.C.B MOUNTING PATTERN DIMENSION

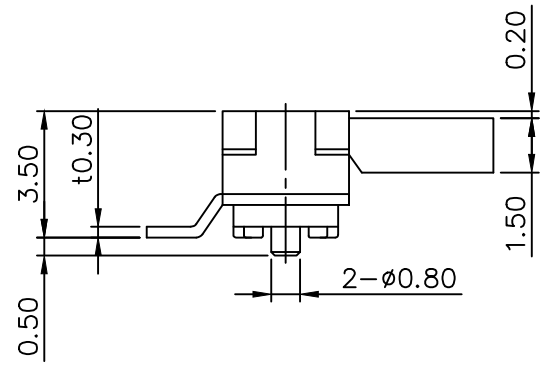
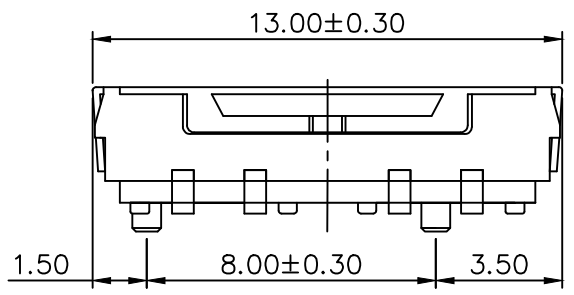
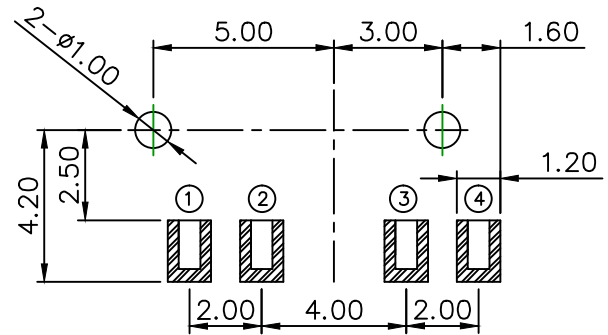

Specifications

1. Rating : DC 12V, 100mA.
2. Travel : 2.0±0.2mm
3. Contact resistance : 100mΩ Max.
4. Insulation resistance : 50MΩ Min.
5. Operating force : 230±70gf
6. Operating life : 10,000 cycles.

達立科技股份有限公司
Dawning Precision Co., Ltd.
TEL: 886-2-82271388 FAX: 886-2-82272198

| | | | | |
|----------|-------|---------|-------------|--|
| DESIGN | Eason | SCALE | | |
| DRAWING | Eason | UNIT | mm | |
| CHECK | Eason | SIZE | A4: 210*297 | |
| APPROVAL | Honda | VERSION | 01 | |

| TOLERANCE UNLESS OTHERWISE STATED(mm) | |
|---------------------------------------|-------|
| 0 | ±0.35 |
| 0.0 | ±0.30 |
| 0.00 | ±0.20 |
| ANGLE | ±2° |

| | |
|------------|---------------------|
| PART NAME | SLIDE SWITCH |
| PART NO | SS-C80x-S085 Series |
| DRAWING NO | |
| DATE | 2017/04/18 |