

RoHS Compatible

△				
△				
△				
△				
ZONE	REV	DESCRIPTION	DATE	APPD.

- NOTES:
- MATERIAL: SEE BOM.
 - SPECIFICATION:
 - ELECTRICAL CHARACTERISTICS:(RMS)
 - CURRENT RATING:2A AC/DC
 - VOLTAGE RATING: 250V AC/DC
 - CONTACT RESISTANCE:MAX.20mΩ
 - INSULATION RESISTANCE: 1000 MΩ (Min).
 - WITHSTAND VOLTAGE: 1000V AC/MINUTE
 - ENVIRONMENT CHARACTERISTICS:
 - OPERATING TEMPERATURE: -25 °C TO +105 °C

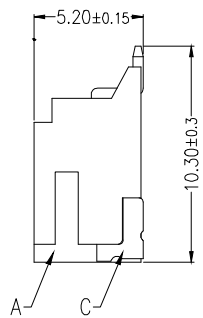
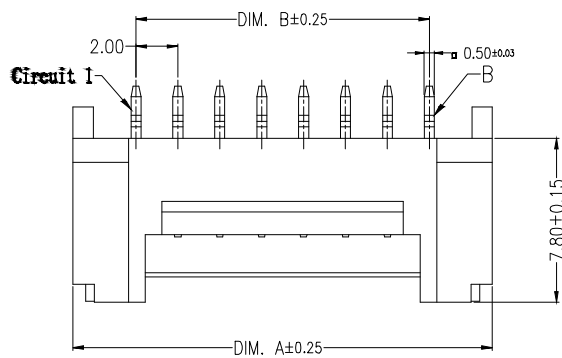

WB2006H-XX X X X - XX

PIN NO.

MATERIAL:
 LC:LCP (NATURAL)
 P6:PA6T (NATURAL)
 P9:PA9T (BLACK)

PLATING SPEC
 S: MATT Sn
 B: Pure Tin
 G: GOLD FLASH

PACKING:
 0: TAPE&REEL
 1: TUBE

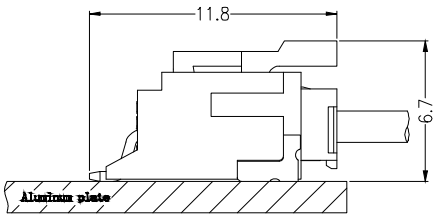
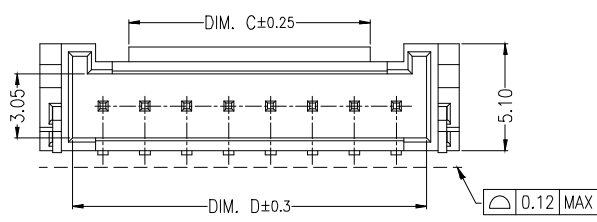

Assembly Layout

Circuits	Dimensions (mm)			
	DIM. A	DIM. B	DIM. C	DIM. D
02	8.00	2.00	2.70	4.75
03	10.00	4.00	3.20	6.75
04	12.00	6.00	3.50	8.90
05	14.00	8.00	5.50	10.90
06	16.00	10.00	7.50	12.90
07	18.00	12.00	9.50	14.90
08	20.00	14.00	11.50	16.90
09	22.00	16.00	13.50	18.90
10	24.00	18.00	15.50	20.90
11	26.00	20.00	15.50	22.90
12	28.00	22.00	15.50	24.90
13	30.00	24.00	15.50	26.90
14	32.00	26.00	15.50	28.90
15	34.00	28.00	15.50	30.90
16	36.00	30.00	15.50	32.90

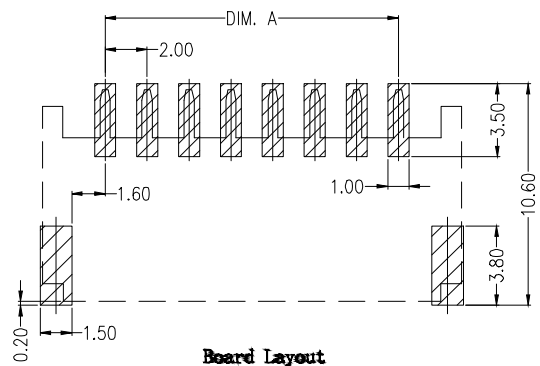

Board Layout
General Tolerance: ±0.05

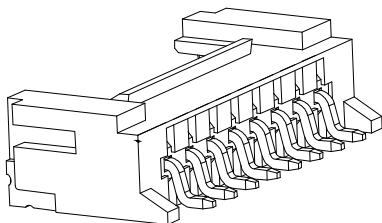

C	SOLDER-TAB	2	BRASS	SN-PLATED
B	CONTACT	XX	BRASS	SN-PLATED
A	HOUSING	1	LCP/PA6T/PA9T	UL94V-0
NO.	DESCRIPTION	Q'TY.	MATERIAL	

達立科技股份有限公司
 Dawning Precision Co., Ltd.
 TEL: 886-2-82271388 FAX: 886-2-82272198

DESIGN	Honda	SCALE		
DRAWING	Honda	UNIT	mm	
CHECK	Honda	SIZE	A4: 210*297	
APPROVAL	Honda	VERSION	01	

TOLERANCE UNLESS OTHERWISE STATED(mm)	PART NAME	WTB WAFER 2.00mm Pitch
0 ——— ±0.35	PART NO	WB2006H SERIES
0.0 ——— ±0.25	DRAWING NO	
0.00 ——— ±0.15	DATE	2020.04.16
ANGLE ——— ±3°		